

pg 280

Courses and Distances
Survey begun
Hickory at No 1

| | N | C | D |
|----|----------|---|-----|
| 1 | N. 34. E | | 28 |
| 2 | N. 71. E | | 90 |
| 3 | N. 44. E | | 47 |
| 4 | N. 17. E | | 42 |
| 5 | N. 48. W | | 30 |
| 6 | N. 83. W | | 79 |
| 7 | S. 73. W | | 60 |
| 8 | N. 75. W | | 48 |
| 9 | N. 87. W | | 17 |
| 10 | N. 19. W | | 75 |
| 11 | N. 14. E | | 26 |
| 12 | N. 5. E | | 22 |
| 13 | N. 22. W | | 30 |
| 14 | N. 7. W | | 22 |
| 15 | N. 51. W | | 26 |
| 16 | S. 13. W | | 62 |
| 17 | S. 19. W | | 78 |
| 18 | S. 42. E | | 104 |
| 19 | S. 23. E | | 70 |
| 20 | S. 87. E | | 18 |
| 21 | N. 55. E | | 52 |
| 22 | S. 60. E | | 102 |
| | | | 460 |

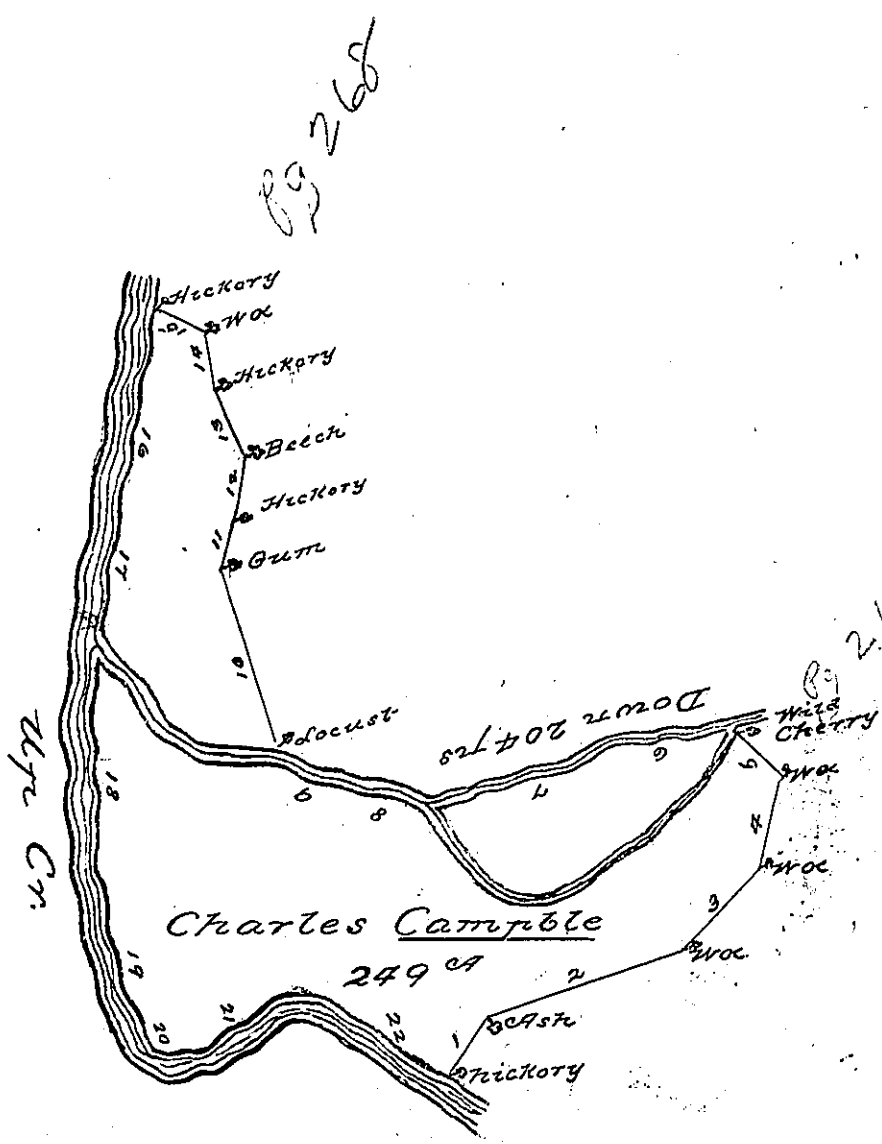

A Draught of a Tract of Land called Cone-
mough (obl.) Town; situated on the East side of
Cone-mough Creek, at the (obl.) of Little Cone-
mough; between the Alleghany and Laurel
Hill in (obl.) land County: Containing Two
Hundred and Forty Nine Acres (obl.) usual
allowance of Six pcent for Roads; Surveyed
the 12th (obl.) May 1770 for Charles Camp-
bell in pursuance of an Order (obl.) Dat^{ed}
April 3^d 1769

now Bedford by Thomas Smith (obl.)
To John Lukens Esq^r }
Surveyor General }

IN TESTIMONY that the above is a copy of the original remaining on file in the
Department of Internal Affairs of Pennsylvania, made con-
formably to an Act of Assembly approved the 16th day of
February, 1833, I have hereunto set my Hand and caused
the Seal of said Department to be affixed at Harrisburg, this
second day of March 1897

James W. Fatta
Secretary of Internal Affairs.